



2026
SELF-TESTING
Product Catalog



V01.2

IN
TEST
WE
TRUST



At **VITROSENS**, we offer a comprehensive portfolio of self-test solutions designed for **fast, reliable**, and **user-friendly** diagnostics across a wide range of health conditions.

From **respiratory infections** and **sexually transmitted diseases** to **fertility, hormones**, and **toxicology screening**, our tests provide accurate results in minutes-empowering individuals to take control of their health, anytime and anywhere.



respiratory tests

| Name | Kit Size |
|---|----------|
| SARS-CoV-2 Antigen Test Kit | 1/2/5 T |
| SARS-CoV-2 & FLU A/B Test Kit | 1/2/5 T |
| SARS-CoV-2 + FLU A/B + RSV Test Kit | 1/2/5 T |
| SARS-CoV-2 + FLU A/B + RSV + ADV Test Kit | 1/2/5 T |
| SARS-CoV-2 + FLU A/B + RSV + ADV + hMPV Test Kit | 1/2/5 T |
| SARS-CoV-2 + FLUA/B + hMPV + HPIV + RSV/ADV Test Kit | 1/2/5 T |
| SARS-CoV-2 + FLUA/B + hMPV + HPIV + MP + RSV/ADV Test Kit | 1/2/5 T |
| SARS-CoV-2 + FLUA/B + hMPV + HPIV + RSV/ADV + MP/RhV Test Kit | 1/2/5 T |
| SARS-CoV-2 + FLUA/B + hMPV + HPIV + RhV + RSV/ADV Test Kit | 1/2/5 T |
| SARS-CoV-2 + FLU A/B + RSV + ADV + M. pneumoniae Test Kit | 1/2/5 T |
| RSV/ADV Test Kit | 1/2/5 T |
| Strep A v2.0 Test Kit | 1/2/5 T |
| Influenza A/B Test Kit | 1/2/5 T |
| Influenza H5 Test Kit | 1/2/5 T |

BOX CONTENT

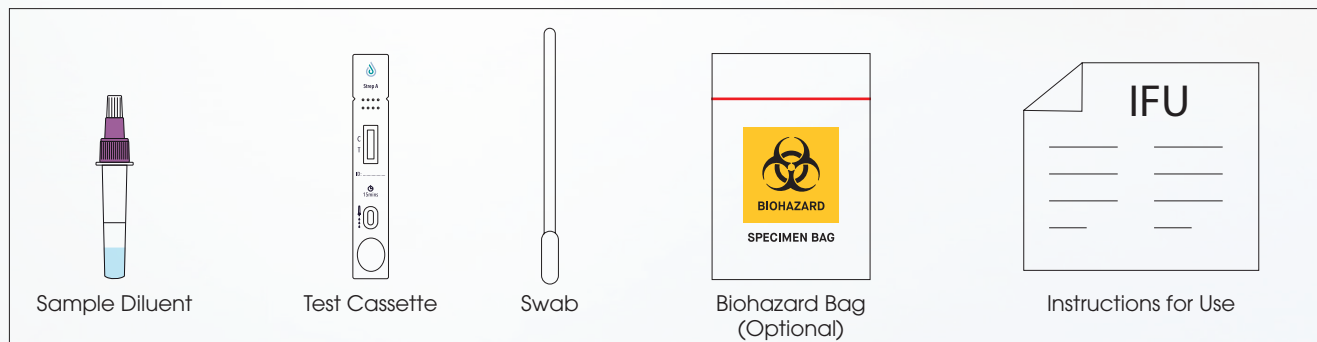

⚠️ Box contents may vary depending on the type of test.

Strep A v2.0 Test Kit

Designed for self-testing, this rapid test offers a practical solution for detecting Group A Streptococcal infection at home. Its optimized formulation supports reliable performance, while the single-buffer system simplifies handling and reduces user steps. Clear result interpretation and rapid turnaround time enable confident decision-making during routine at-home self-testing, with clear guidance provided for users worldwide.



| Ref No | Name | Kit Size |
|----------|-----------------------|----------|
| VMD150ST | Strep A v2.0 Test Kit | 1/2/5 T |

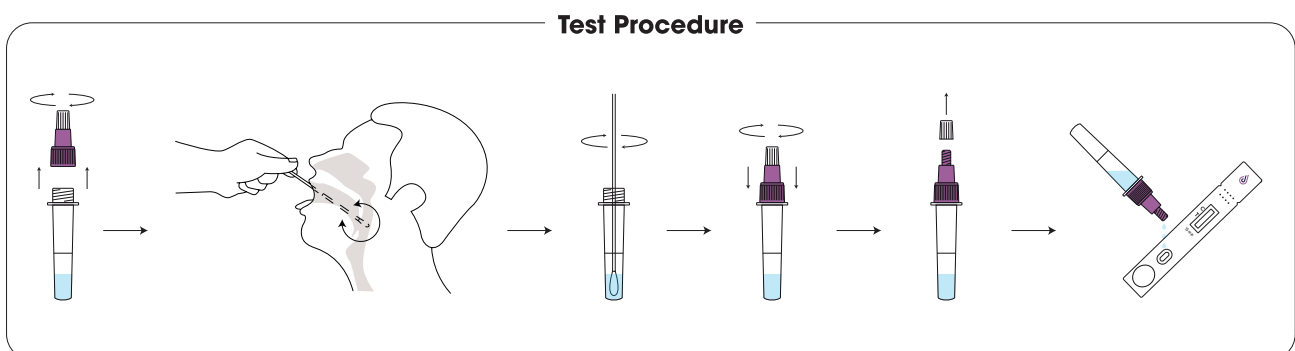

SARS-CoV-2 + FLU A/B + RSV + ADV Test Kit (Nasal)

Designed for convenient self-testing, this combined nasal test enables rapid detection of SARS-CoV-2, Influenza A/B, RSV, and Adenovirus from a single sample. The single-buffer, multi-result cassette simplifies operation while delivering clear, easy-to-read results. Rapid turnaround time supports timely decision-making during at-home respiratory symptom assessment and helps users manage infections responsibly without complex procedures or equipment.

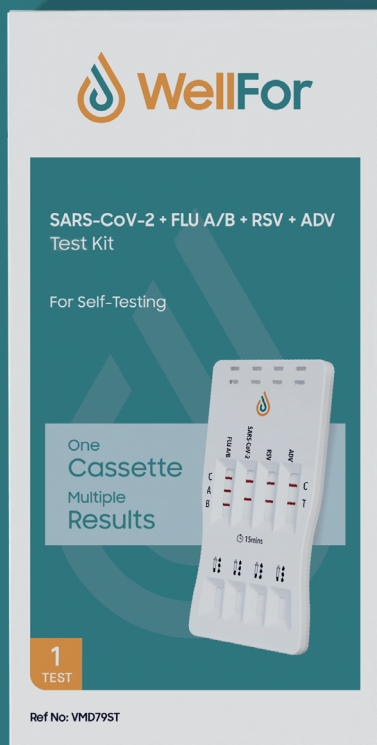

Single Buffer
Multi Result

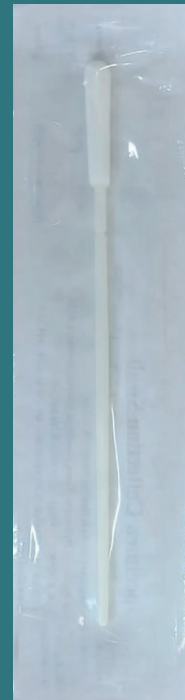
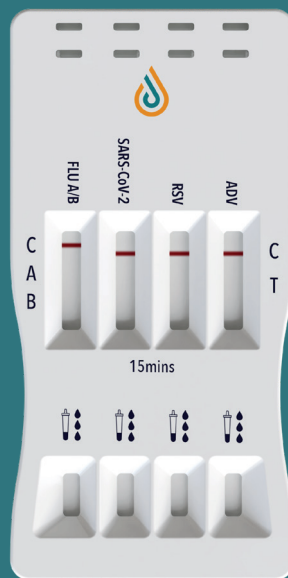

| Ref No | Name | Kit Size |
|---------|---|----------|
| VMD79ST | SARS-CoV-2 + FLU A/B + RSV + ADV Test Kit (Nasal) | 1/2/5 T |

Test Procedure

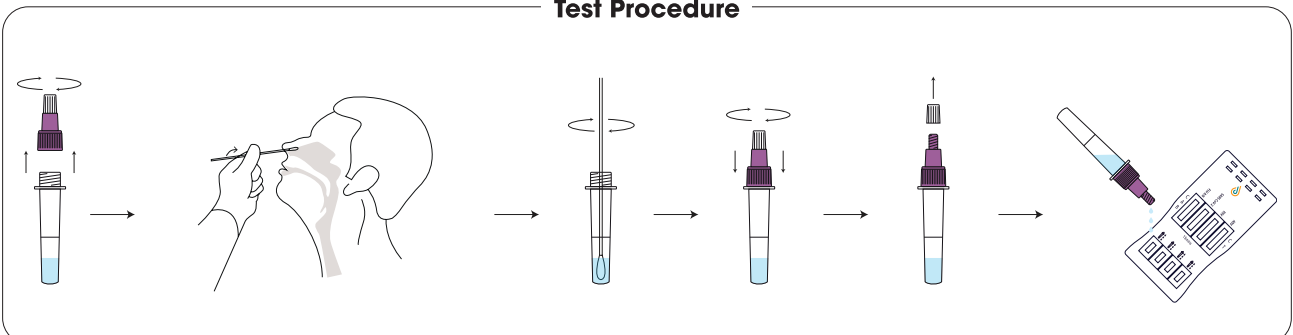



sexually transmitted infection tests

| Name | Kit Size |
|----------------------------|----------|
| Vaginal pH Swab | 1/2/5 T |
| Candida Ag (Candida spp.) | 1/2/5 T |
| HSV (1/2) Ag | 1/2/5 T |
| Chlamydia (CT) | 1/2/5 T |
| Gonorrhea (NG) | 1/2/5 T |
| Trichomonas (TV) | 1/2/5 T |
| Candida Albicans (CA) | 1/2/5 T |
| Gardnerella Vaginalis (GV) | 1/2/5 T |
| Mycoplasma Genitalium (MG) | 1/2/5 T |
| CT + NG | 1/2/5 T |
| CT/NG | 1/2/5 T |
| CT + NG + TV | 1/2/5 T |
| CT/NG + TV | 1/2/5 T |
| CA + GV + TV | 1/2/5 T |
| CA + GV + MG | 1/2/5 T |
| HIV (1/2) Ab (Oral fluid) | 1/2/5 T |
| Syphilis Ab | 1/2/5 T |

BOX CONTENT



 **Box contents may vary depending on the type of test.**

HIV (1/2) Ab Test Kit (Oral Fluid)

The HIV (1/2) Test Kit (Oral Fluid) is a qualitative immunochromatographic self-test for the detection of antibodies to Human Immunodeficiency Virus types 1 and 2 (anti-HIV-1 and anti-HIV-2) in human oral fluid samples. The test is intended for initial at-home screening and provides easy-to-read results within minutes. Positive results should be confirmed using an alternative testing method.

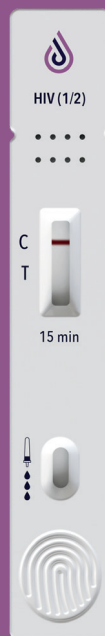

| Ref No | Name | Kit Size |
|---------|------------------------------------|----------|
| VMD13ST | HIV (1/2) Ab Test Kit (Oral Fluid) | 1/2/5 T |

Test Procedure

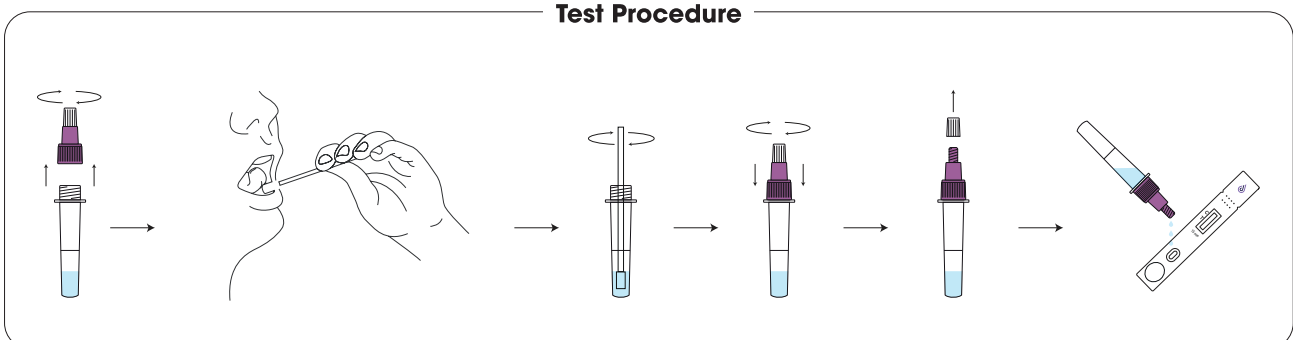

Syphilis Ab Test Kit

Designed for self-testing, this rapid assay supports reliable screening for syphilis antibodies using a small blood sample. An intuitive workflow supports clear result interpretation while maintaining user comfort and discretion. Fast turnaround time helps individuals take timely action, encouraging informed decisions and responsible follow-up during private at-home testing for routine sexual health awareness worldwide.



| Ref No | Name | Kit Size |
|---------|----------------------|----------|
| VMD04ST | Syphilis Ab Test Kit | 1/2/5 T |

Test Procedure

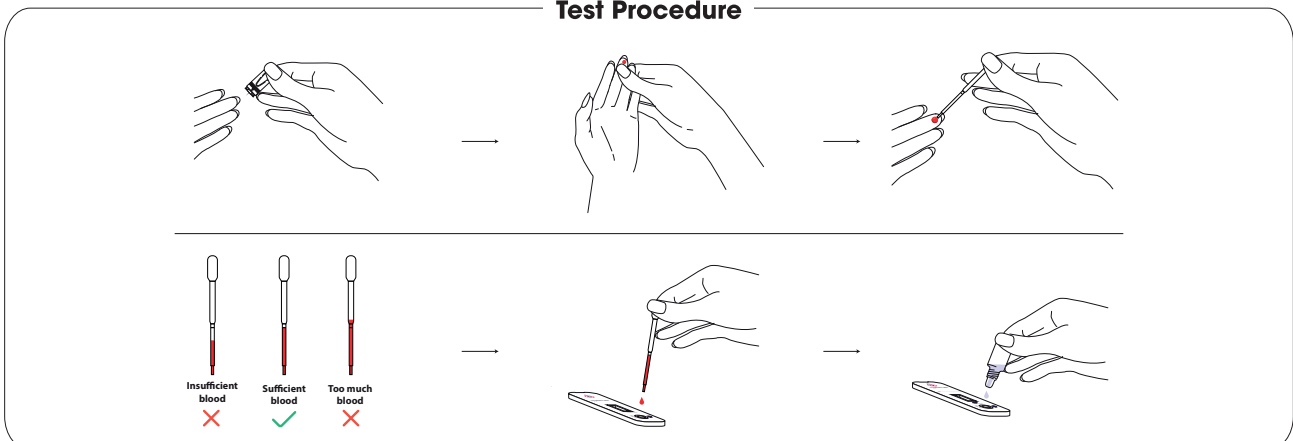



 WellFor

Ferritin
Test Kit

1
TEST

Ref: VMD97ST
Model: VMD97ST0IFCLA

 WellFor

Vitamin D
Test Kit

1
TEST

Ref: VMD64ST
Model: VMD64ST0IFCLA

 WellFor

TSH Test Kit

1
TEST

Ref: VMD98ST
Model: VMD98ST0IFCLA

hormone tests

| Name | Kit Size |
|--------------------|----------|
| Vitamin D Test Kit | 1/2/5 T |
| Ferritin Test Kit | 1/2/5 T |
| TSH Test Kit | 1/2/5 T |

BOX CONTENT

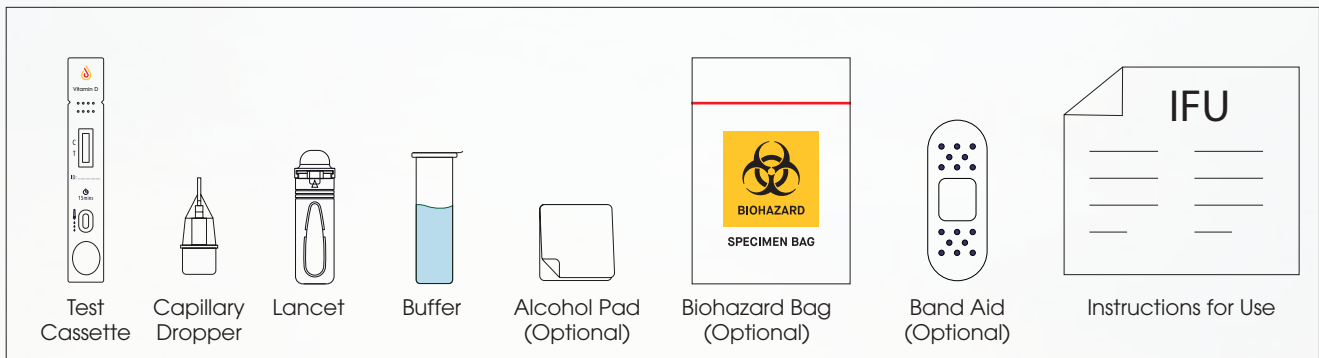

⚠ Box contents may vary depending on the type of test.

Vitamin D Test Kit

Ideal for personal health monitoring, this rapid test provides a simple way to assess Vitamin D levels using a small blood sample. The intuitive procedure supports clear result interpretation without unnecessary complexity. Fast results help users understand their Vitamin D status promptly, supporting informed lifestyle and nutritional decisions during routine at-home wellness monitoring with confidence and daily balance.



| Ref No | Name | Kit Size |
|---------|---------------------|----------|
| VMD64ST | Vitamin D Test Kit) | 1/2/5 T |

Test Procedure

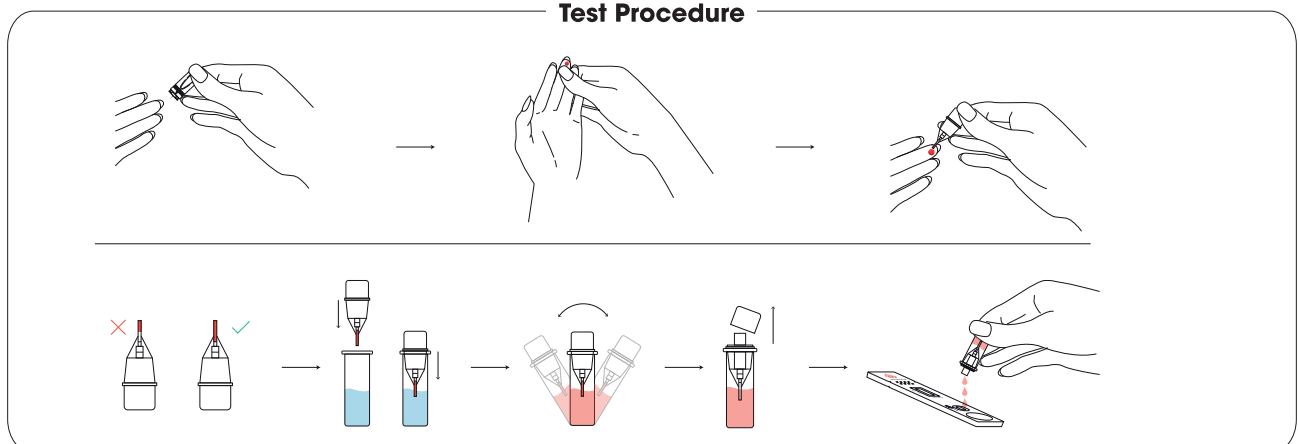

Ferritin Test Kit

Focused on everyday wellness insights, this rapid ferritin test offers a simple way to evaluate iron storage levels using a small blood sample. The streamlined procedure supports clear result interpretation without technical complexity. Fast results assist users in recognizing potential deficiency trends early, encouraging timely lifestyle adjustments or professional consultation during routine at-home health monitoring for improved awareness.



| Ref No | Name | Kit Size |
|---------|-------------------|----------|
| VMD97ST | Ferritin Test Kit | 1/2/5 T |

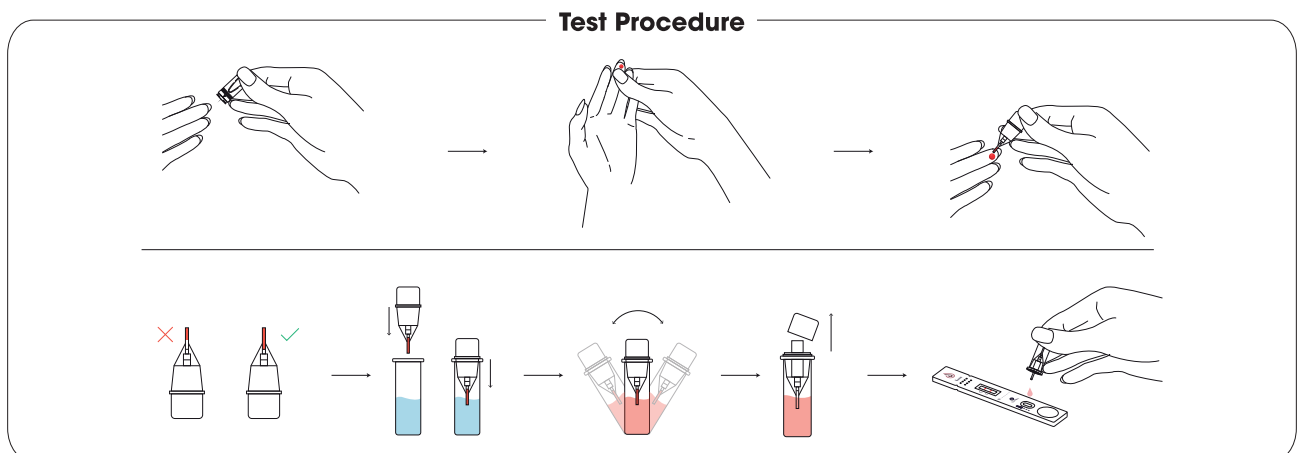



tumor marker tests

| Name | Kit Size |
|--------------|----------|
| FOB Test Kit | 1/2/5 T |
| PSA Test Kit | 1/2/5 T |

BOX CONTENT



⚠ Box contents may vary depending on the type of test.

FOB Test Kit

Supporting preventive health awareness, this rapid FOB test enables convenient at-home screening for hidden blood in stool samples. The simple collection process supports clear result interpretation without discomfort. Fast results help users recognize potential concerns early, encouraging timely medical consultation and informed follow-up decisions during routine colorectal health monitoring with confidence and discretion for everyday personal home use.

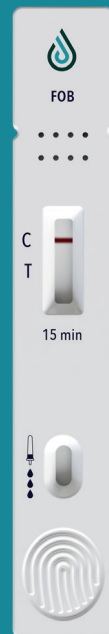

| Ref No | Name | Kit Size |
|---------|--------------|----------|
| VMD09ST | FOB Test Kit | 1/2/5 T |

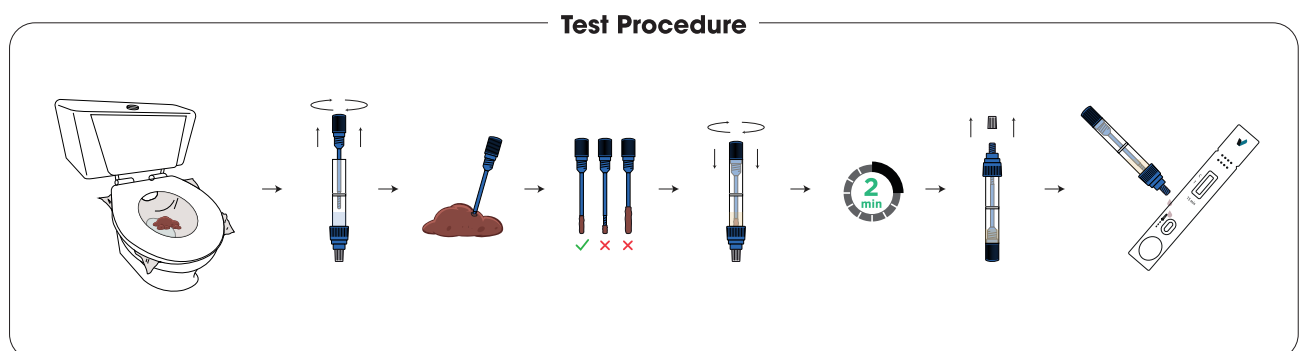

PSA Test Kit

Designed to support early prostate health screening, this rapid PSA test enables convenient at-home testing using a small blood sample. The straightforward procedure allows clear result interpretation without technical complexity. Fast results help users identify elevated PSA levels at an early stage, encouraging timely discussion with healthcare professionals during routine self-testing and ongoing personal health monitoring.



| Ref No | Name | Kit Size |
|---------|--------------|----------|
| VMD46ST | PSA Test Kit | 1/2/5 T |

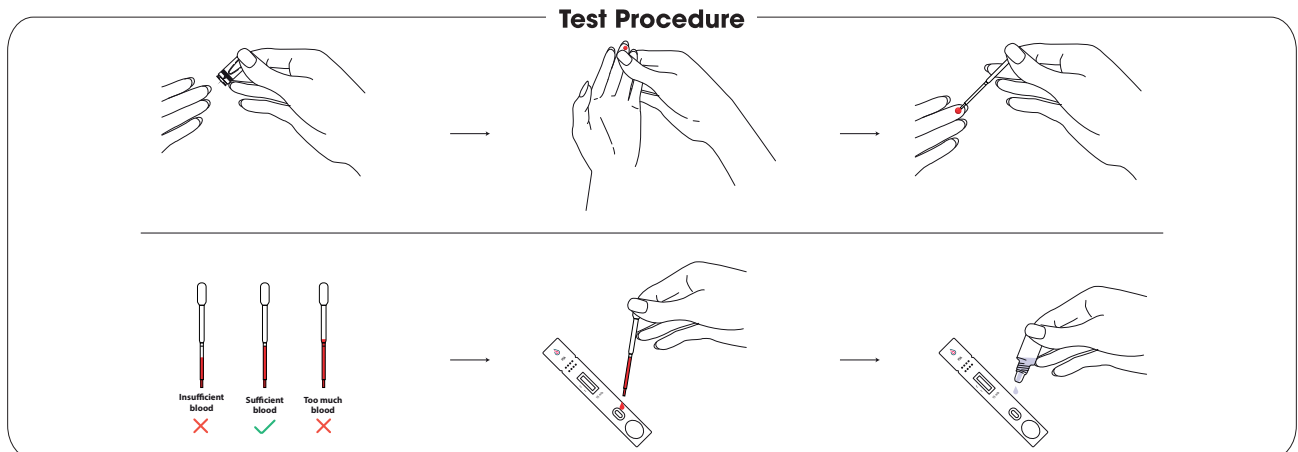



fertility tests

| Name | Kit Size |
|--------------------------|----------|
| Sperm Concentration Test | 1/2/5 T |
| Early Pregnancy Test Kit | 1/2/5 T |
| Ovulation LH Test Kit | 1/2/5 T |
| FSH (Menopause) Test Kit | 1/2/5 T |

SPERM CONCENTRATION TEST BOX CONTENT

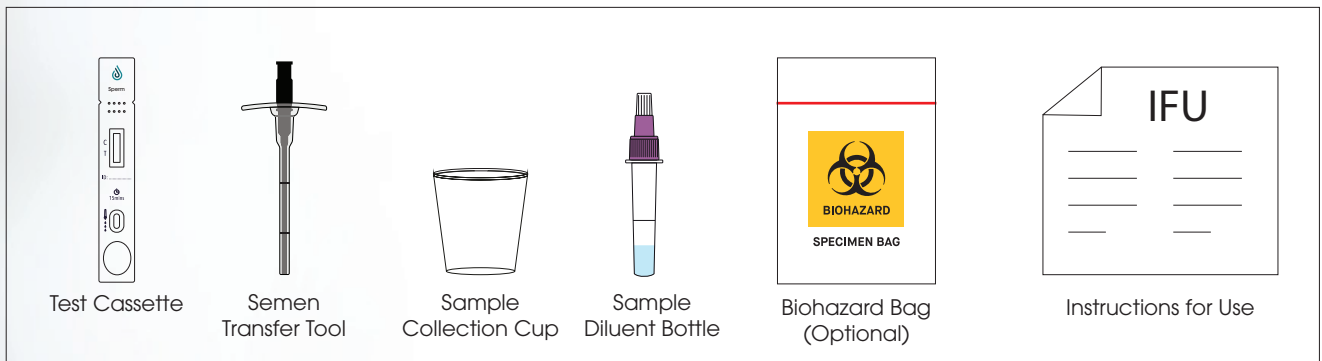

⚠️ Box contents may vary depending on the type of test.



Early Pregnancy Test Kit

Designed to offer flexible testing options, this early pregnancy test detects pregnancy hormones at very early stages using urine samples. Available in cassette and midstream formats, it adapts to different user preferences. Clear results within minutes provide timely reassurance, supporting confident next steps during private at-home testing without complicated procedures, special equipment, or prior testing experience for users.



| Ref No | Name | Kit Size | Cut-off |
|----------------------|--------------------------|----------|-----------|
| VMD59MST (Midstream) | Early Pregnancy Test Kit | 1/2/5 T | 10 mIU/ml |
| VMD59CST (Cassette) | Early Pregnancy Test Kit | 1/2/5 T | 10 mIU/ml |
| VMD59SST (Strip) | Early Pregnancy Test Kit | 1/2/5 T | 10 mIU/ml |

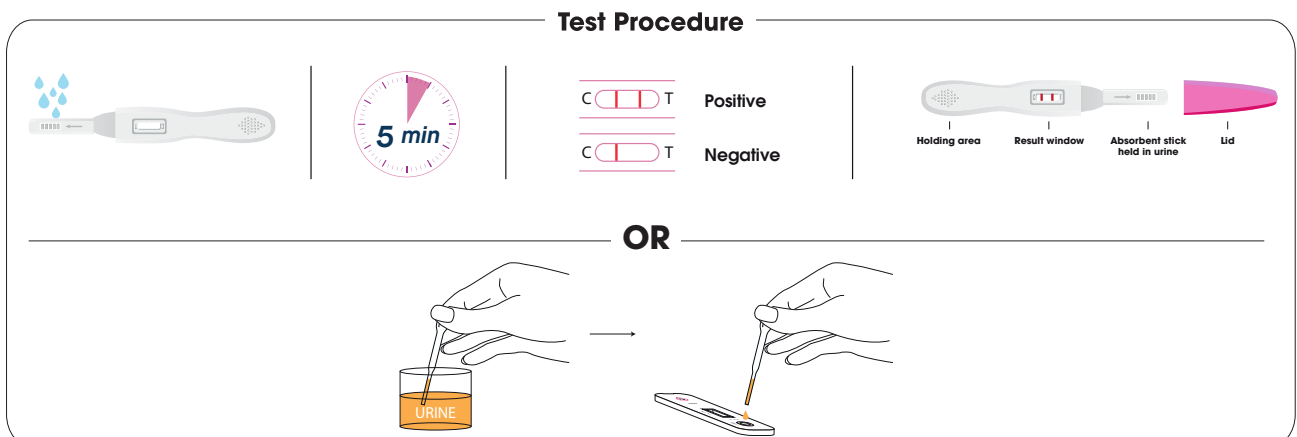

Ovulation LH Test Kit

Supporting fertility planning, this ovulation LH test helps identify fertile days by detecting the luteinizing hormone surge in urine samples. Available in cassette and midstream formats, it offers flexible testing options. Clear results within minutes support accurate cycle tracking, enabling informed timing decisions during routine at-home fertility monitoring without complicated steps or additional equipment.



| Ref No | Name | Kit Size | Cut-off |
|----------|-----------------------|----------|-----------|
| VMD61MST | Ovulation LH Test Kit | 1/2/5 T | 25 mIU/ml |
| VMD61CST | Ovulation LH Test Kit | 1/2/5 T | 25 mIU/ml |
| VMD61SST | Ovulation LH Test Kit | 1/2/5 T | 25 mIU/ml |

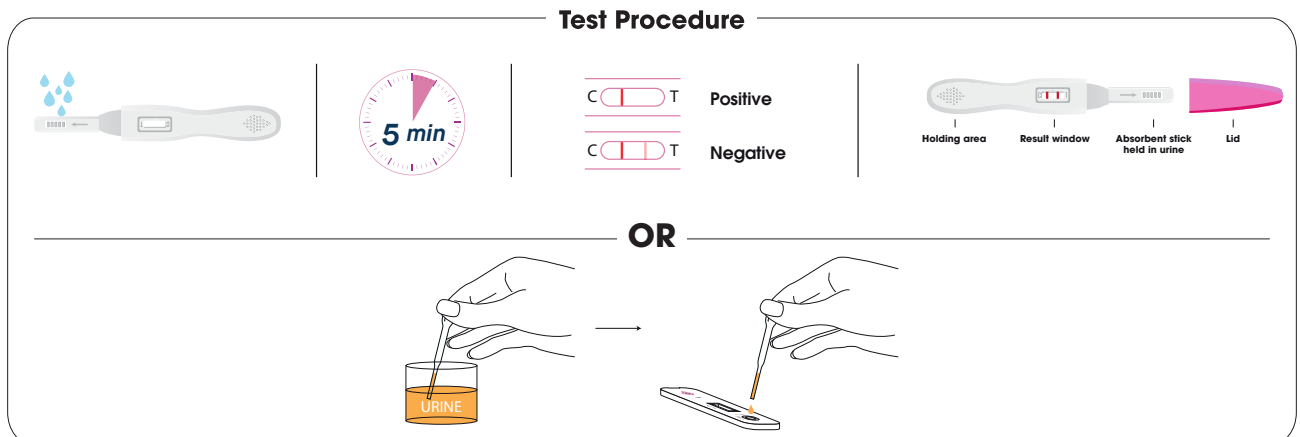

urinary tract
infection (UTI) test



UTI Strip Test

Offering quick insight into urinary health, this UTI strip test supports at-home screening by detecting leukocytes and nitrite in urine samples. The strip is briefly held in the urine stream, allowing hygienic use and fast visual interpretation without instruments. Rapid results help users recognize potential signs of infection early, encouraging timely medical attention and informed decisions during self-monitoring.



| Ref No | Name | Kit Size |
|----------|----------------|----------|
| VMD106ST | UTI Strip Test | 1/2/5 T |

Test Procedure

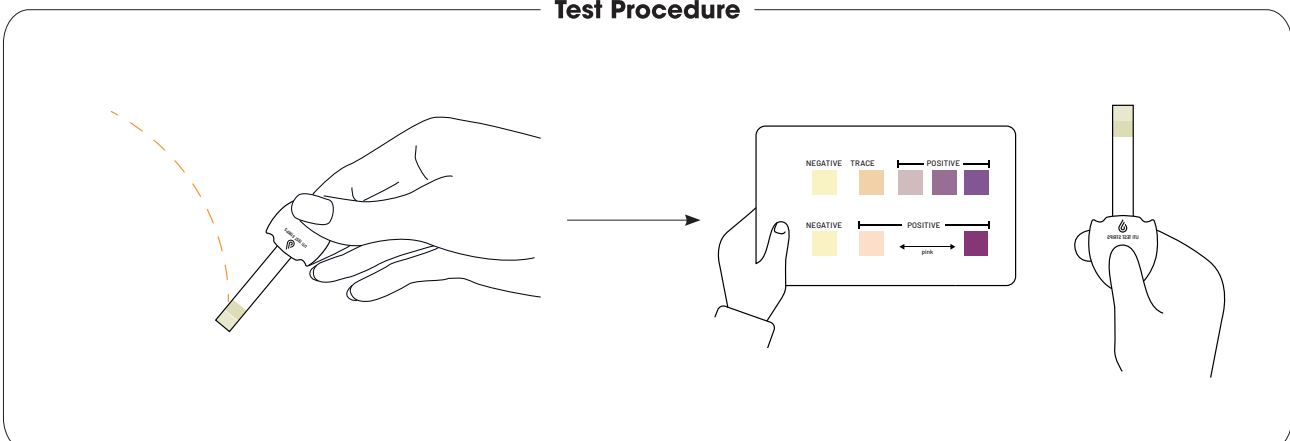



digestive tract tests

| Name | Kit Size |
|-----------------------------|----------|
| H.Pylori Test Kit | 1/2/5 T |
| Gluten Intolerance Test Kit | 1/2/5 T |

BOX CONTENT



 **Box contents may vary depending on the type of test.**

H.Pylori Test Kit

Providing a convenient option for digestive health screening, this rapid H. pylori test supports at-home detection using a simple sample collection method. The user-friendly design allows clear result interpretation within minutes. Fast results help individuals recognize potential infection early, supporting timely action and informed discussions with healthcare professionals during routine self-testing at home with confidence and personal reassurance.

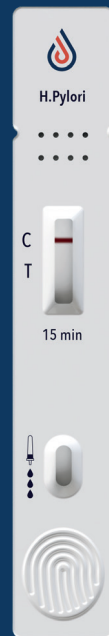

| Ref No | Name | Kit Size |
|---------|-------------------|----------|
| VMD16ST | H.Pylori Test Kit | 1/2/5 T |

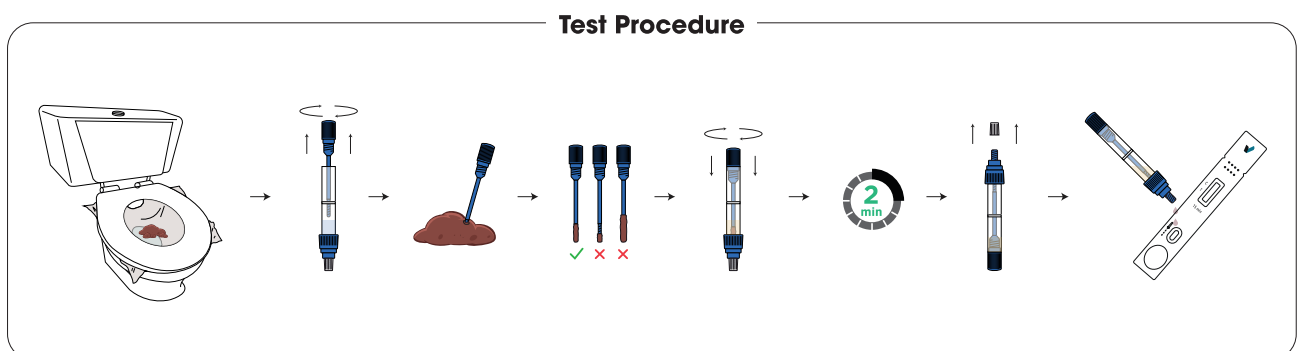

Gluten Intolerance Test Kit

Supporting dietary awareness, this rapid gluten intolerance test helps identify potential sensitivity using a small blood sample. The straightforward procedure enables clear result interpretation within minutes. Fast results assist users in understanding gluten-related responses early, supporting informed nutritional choices and confident discussions with healthcare professionals during routine at-home testing for everyday digestive wellness monitoring and long-term dietary management.



| Ref No | Name | Kit Size |
|---------|-----------------------------|----------|
| VMD63ST | Gluten Intolerance Test Kit | 1/2/5 T |

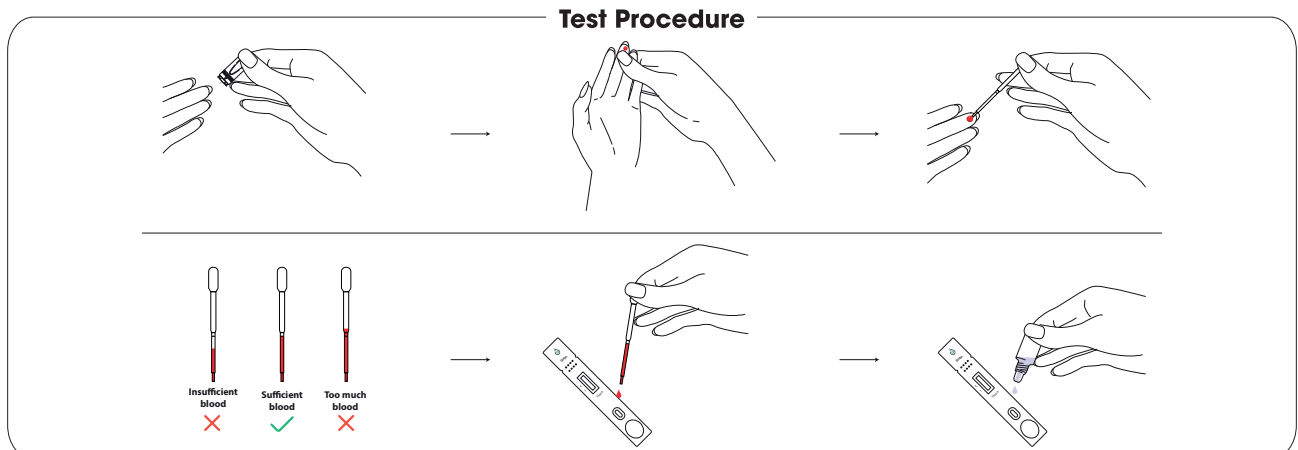

allergy test



Total IgE Test Kit

Designed to support allergy screening, this rapid Total IgE test helps assess overall allergic response using a small blood sample. The intuitive procedure allows clear result interpretation within minutes. Fast results assist users in identifying elevated IgE levels early, supporting informed lifestyle adjustments and discussions with health-care professionals during routine at-home monitoring.



| Ref No | Name | Kit Size |
|----------|--------------------|----------|
| VMD121ST | Total IgE Test Kit | 1/2/5 T |

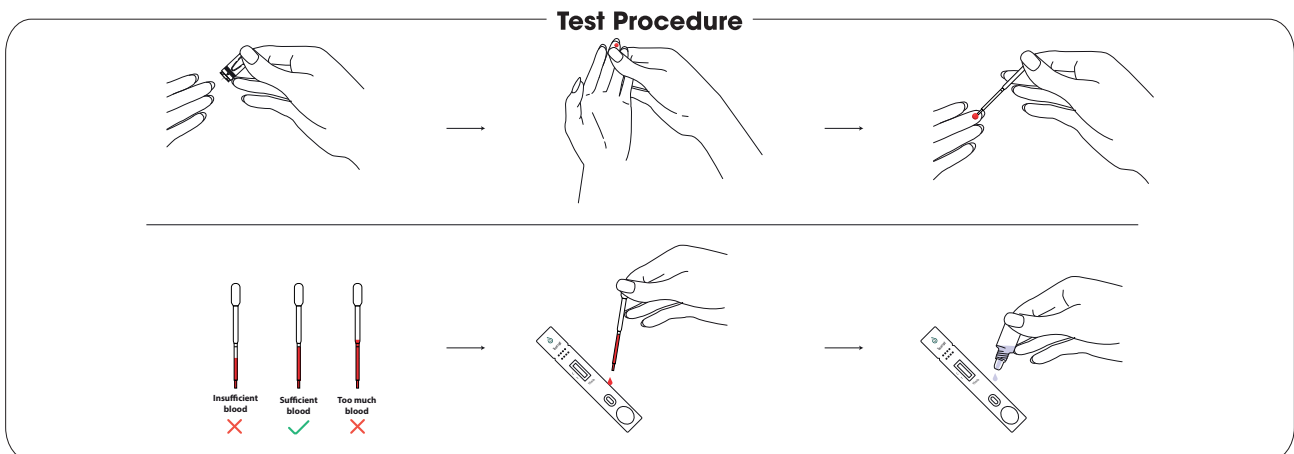

toxicology tests

Covering diverse toxicology needs, these rapid drug tests support convenient self-screening for alcohol and multiple substances. Available in cassette, cup, and saliva formats, they accommodate different user preferences. Clear visual results and fast turnaround enable informed decisions during routine workplace, on-site, or personal screening without professional equipment or specialized training, suitable for use across varied non-professional settings worldwide.

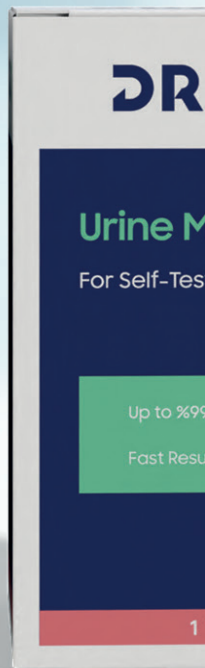
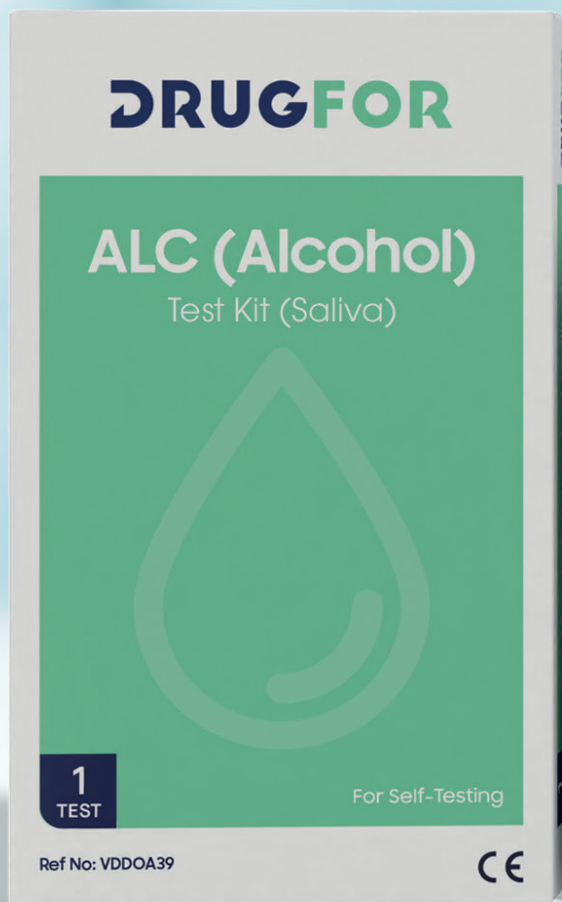

| Name | Kit Size |
|-------------------------------------|----------|
| Saliva Multi-Drug Test Kit | 1/2/5 T |
| Saliva Multi-Drug Test Cup | 1/2/5 T |
| Urine Multi-Drug Test Cup | 1/2/5 T |
| Urine Multi-Drug Test Cup (Key Cup) | 1/2/5 T |
| ALC (Alcohol) Test (Saliva) | 1/2/5 T |

BOX CONTENT

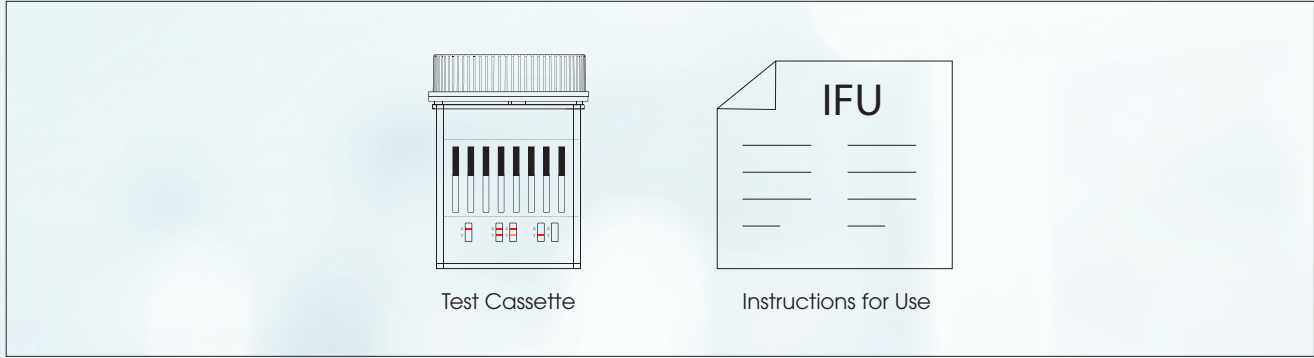

⚠ Box contents may vary depending on the type of test.



Optimized Display, Maximum Impact

Vitrosens' shelf-ready packaging solutions are designed to enhance retail visibility and streamline stocking. Thoughtfully engineered display boxes and compact retail units allow pharmacies and healthcare outlets to present diagnostic self-tests in a clean, organized, and attractive format, ready to go directly from shipment to shelf.





IN TEST WE TRUST

vitrosens.com